

Z-PLUG & Cisco Access Point Compatibility

Ethernet port connection using Siemon Z-PLUG

Cisco 9136 (indoor)
Cisco 9130 (indoor)
Cisco 9166 (indoor)
Cisco 9167 (outdoor)
Cisco 9124 (outdoor)

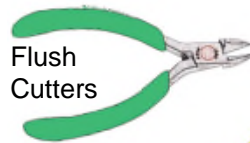

Flush Cutters

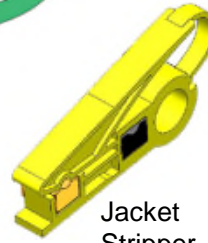

Jacket Stripper

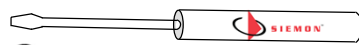

Small flat screwdriver



Z-PLUG Termination tool (p/n: Z-TOOL-ZP)

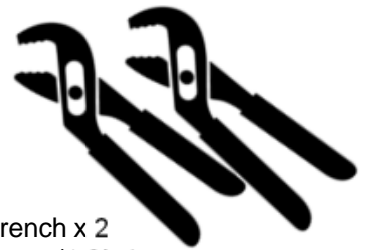

Wrench x 2
30mm (1.2in.)

TOOLS



p/n: ZP1-6AS-01S
(w/latch protector)



p/n: ZP1-6AS-00S
(w/out latch protector)



PG13.5 Cable gland
p/n: ZPG-MA00

OUTDOOR DEVICE KITS

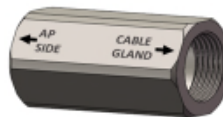

Adapter Gland



Cable gland

= K1 Kit p/n: ZPG-MA00-K1

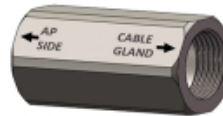

Adapter Gland



Cable Gland



Z-PLUG

Z-PLUG tool

= K2 Kit p/n: ZPG-MA00-K2



Cable Gland



Z-PLUG w/out
Latch Protector



Z-PLUG tool

= K3 Kit p/n:
ZPG-MA00-K3



<< Scan for
Z-PLUG instructions or go
to site link at Siemon.com



Z-PLUG Instructions

https://s3.amazonaws.com/files.siemon.com/int-download-installation-instructions/wa_z-plug-termination_ii.pdf

Products

Z-PLUG & Cisco Access Point Compatibility

Cisco Catalyst 9136 & Cisco Catalyst 9166



Z-PLUG fits with or without optional boot & latch protector

Z-PLUG with boot & latch protector



OR

Z-PLUG without boot & latch protector



Cisco Catalyst 9130



Cisco C9130AXE



Z-PLUG used without optional boot & latch protector

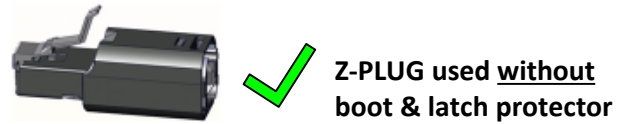

Z-PLUG & Cisco Access Point Compatibility

Cisco Catalyst 9124



Cisco C9124AXi

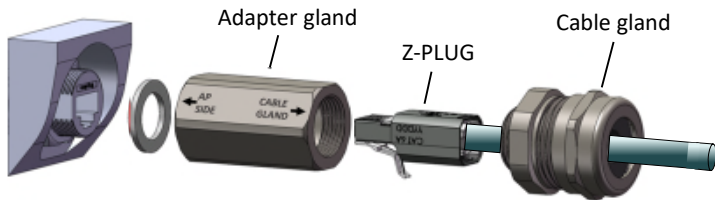

Z-PLUG used without boot latch protector p/n: ZP1-6AS-00S



✓ Z-PLUG (w/out boot or Latch Protector)



✓ PG13.5 cable gland

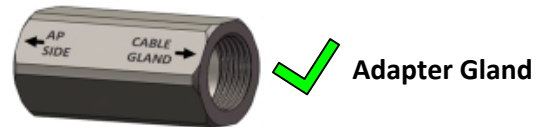

✓ Adapter Gland

Use Kit -K1 or Kit -K2:

p/n: ZPG-MA00-K1 (Use if Z-PLUG not needed)

p/n: ZPG-MA00-K2 (Use if Z-PLUG is needed)

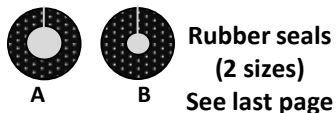

Rubber seals
(2 sizes)
See last page

Cable O.D.

A: 0.28-0.39" (7-10mm)

B: 0.2-0.3" (5-7.5mm)

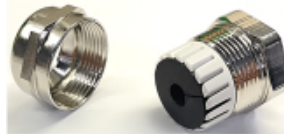

Use appropriate size rubber seal (see last page)

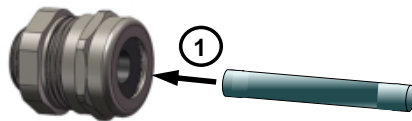

Terminate ZPLUG

Scan for >>
Z-PLUG
instructions

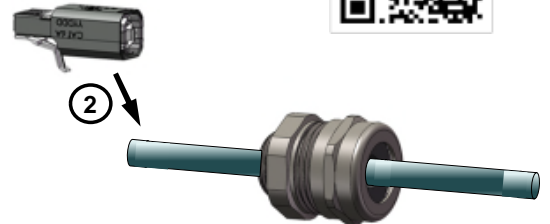

1. Insert outdoor rated cable through the cable gland
2. Terminate Z-PLUG in accordance with Z-PLUG instructions (scan QR code for instructions or go to Siemon.com Product Installation)
3. Thread the adapter gland onto the AP ethernet port (hand tighten – add ¼ of a turn after gland bottoms out against AP).

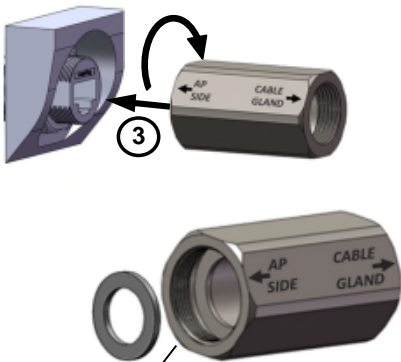

AP Side of Adapter gland
(ensure gasket is installed)

Continued...

Z-PLUG & Cisco Access Point Compatibility

Cisco Catalyst 9124 (Continued)



Installer Tip (recommended):

Bend Z-PLUG latch flat as shown here to allow audible click into ethernet port. Remove by unscrewing adapter gland until release.

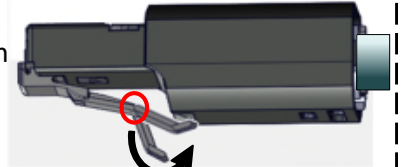

Bend Latch arm straight to allow for audible click when inserting.

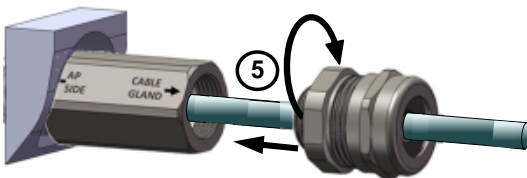
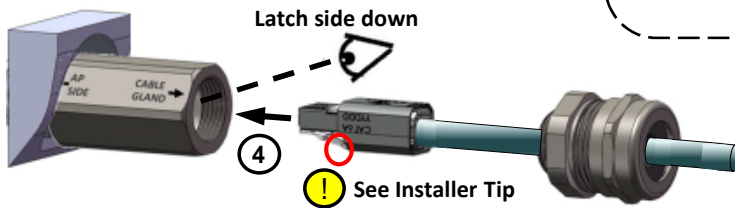

Torque = 6-8 Nm (4.4-5.9 Ft-Lbs)

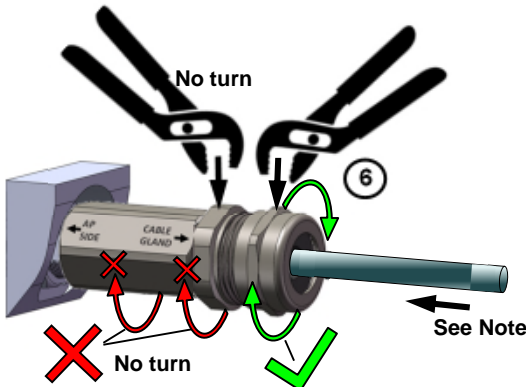

④. Insert terminated Z-PLUG into the ethernet port of the AP (audible click will be heard with straightened latch)

⑤. Slide cable gland into position and thread onto adapter gland. Secure adapter gland to prevent turning while tightening cable gland.

⑥. Tighten rear compression nut of cable gland to securely seal around cable jacket (if necessary, maintain inward cable pressure while tightening) – See note*



*Note: If the installer tip was not used, the plug latch will still engage properly but you may not hear the audible click. You can easily verify this. If the plug was aligned properly and fully inserted gently pull on the cable. The ZPLUG will not come out if engaged into the ethernet port properly. Removal can only be accomplished by unscrewing the adapter gland a minimum of 2 full turns at which point the latch will depress automatically.

Z-PLUG & Cisco Access Point Compatibility

Cisco Catalyst 9167



Cisco IW9167EH

Use Kit -K3:
p/n: ZPG-MA00-K3

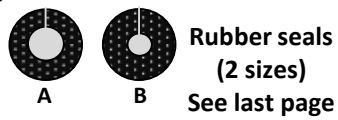
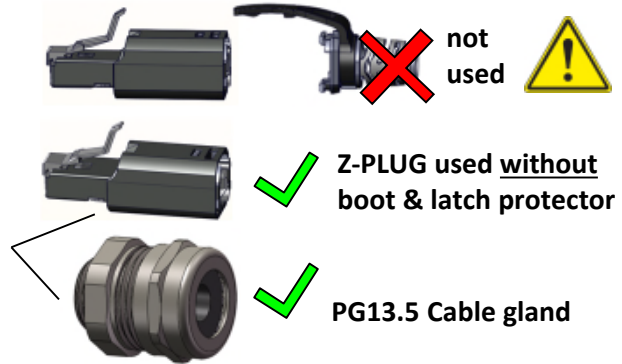

Rubber seals
(2 sizes)
See last page

Cable O.D.

A: 0.28-0.39" (7-10mm)
B: 0.2-0.3" (5-7.5mm)



Use appropriate size rubber seal (see last page)

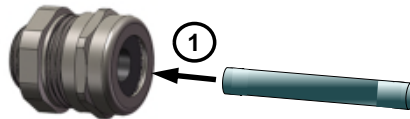

Terminate ZPLUG

Scan for >>
Z-PLUG
instructions



! Installer Tip
(recommended): Bend Z-PLUG latch flat as shown here to allow audible click into ethernet port.

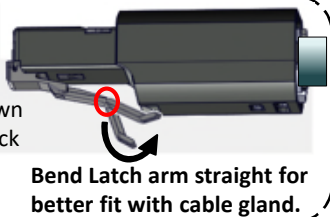

- ①. Insert outdoor rated cable through the cable gland
- ②. Terminate Z-PLUG in accordance with Z-PLUG instructions (scan QR code above). See installer tip **!**
- ③. Insert terminated Z-PLUG into the ethernet port of the AP (audible click will be heard with straightened latch)
- ④. Slide cable gland into position (ensure Z-PLUG latch is captured under threads of gland). Thread securely onto AP.
- ⑤. Tighten rear compression nut of cable gland securely to seal around cable jacket (if necessary, maintain inward cable pressure while tightening) – See note* **!**

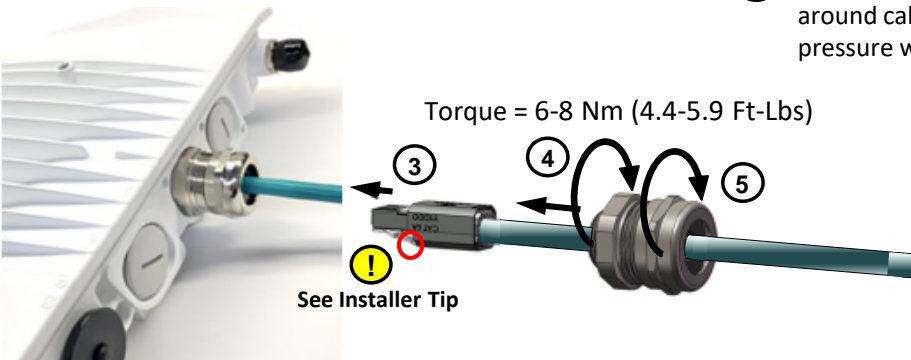

*Note: If the installer tip was not used and the plug latch engagement was not heard the ZPLUG latch will still engage properly but you may not hear the audible click. Verify the plug is fully inserted by simply tugging on the cable to ensure the ZPLUG does not come out.

Z-PLUG & Cisco Access Point Compatibility

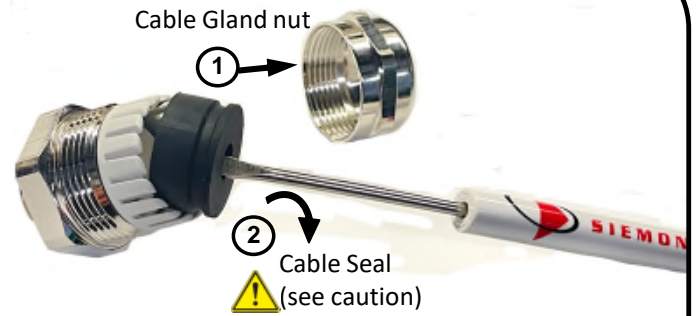
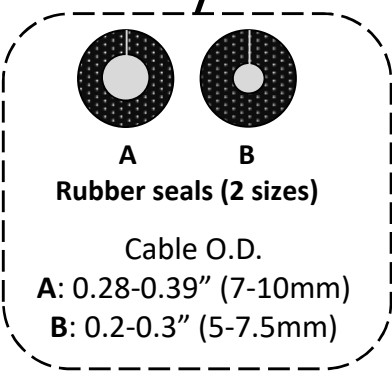
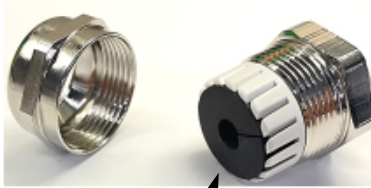
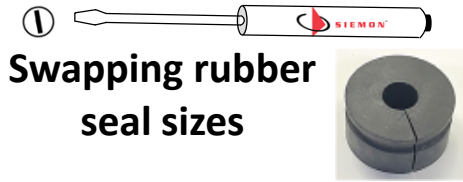

- ① Remove Rear cable gland nut
- ② Pry out rubber seal
- ③ Replace with correctly sized seal (flat side out and flush as shown below)
- ④ Reattach cable gland nut



ONLY REMOVE THE RUBBER SEAL, DO NOT PRY OUT OR DISLODGE THE PLASTIC CLAMPING CLAW SECTION AS THIS MAY BE DIFFICULT TO REPLACE PROPERLY.

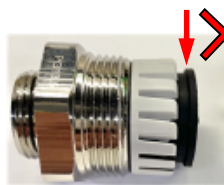

Seal not seated

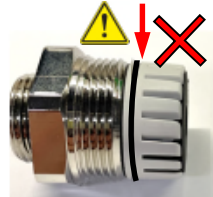

Claw dislodged

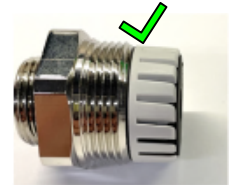

Correct

END

Please direct any questions regarding this document to:
Siemon_NA_TSG@siemon.com

To assist safe installations, comply with the following:

- A. Use caution when installing or modifying telecommunications circuits.
- B. Never touch uninsulated wire terminals unless the circuit has been disconnected.
- C. Never install this device in a wet location.
- D. Never install wiring during a lightning storm.

Lors de l'installation, respectez les consignes de sécurité suivantes:

- A. Utiliser avec prudence lors de l'installation ou de la modification circuits de télécommunications.
- B. Ne jamais toucher les bornes de fil métallique non isolés sauf si le circuit a été débranché.
- C. Ne jamais installer cet appareil dans un endroit humide.
- D. Ne jamais installer pendant un orage.



To ensure you have the latest revision to this document, please visit: www.siemon.com

Global Headquarters
 Watertown, Connecticut USA
 Tel: (1) 866-548-5814

For a complete listing of our global offices visit our web site