

Surface Pack Instructions

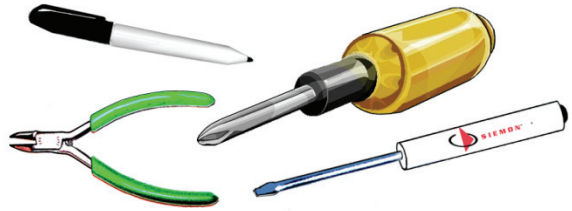

3-port

6-port
(shown throughout)



Tools

Also refer to applicable outlet termination instructions for additional required tools.

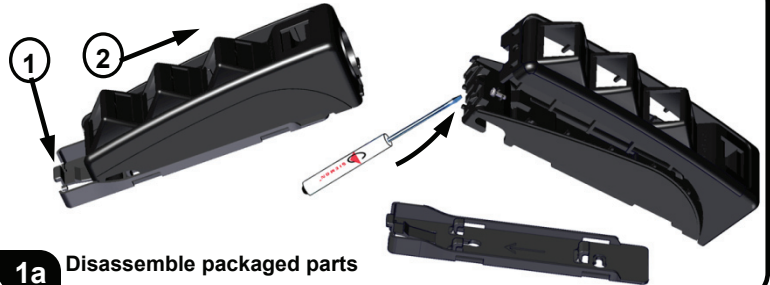

1a Disassemble packaged parts

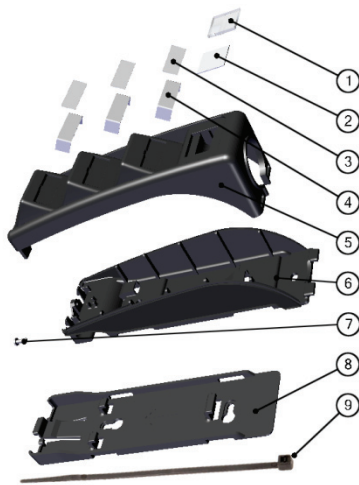

BOM ID	Description	Qty
1	Box label cover	1
2	Box label	1
3	Port label cover	3
4	Port label	3
5	Top cover	1
6	Base	1
7	Securing Screw	1
8	Cradle Bracket	1
9	Tie wrap	1

1b

Cable prep. if conduit system is used

Customer supplied flexible conduit. Dim. for reference:
~25mm I.D. for 6-port version
~20mm I.D. for 3-port version

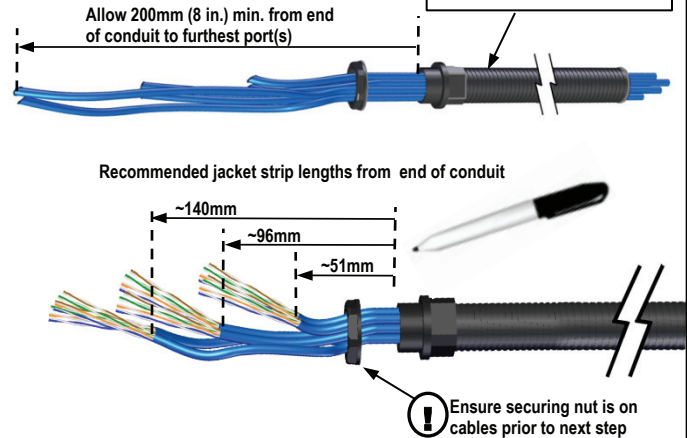

2a

Measure, mark, & strip cables

Terminate desired MAX series compatible outlets

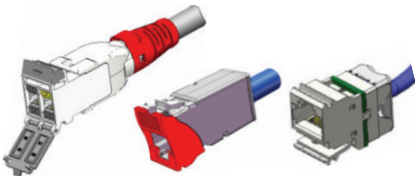

Refer to applicable instructions included with product or listed on line:

www.siemon.com/us/download/installation.asp

- **Z-MAX** or
- **Punch-down MAX** or
- **IERA 4-pair outlet**

2b



Orient outlets with plug latching side up

3

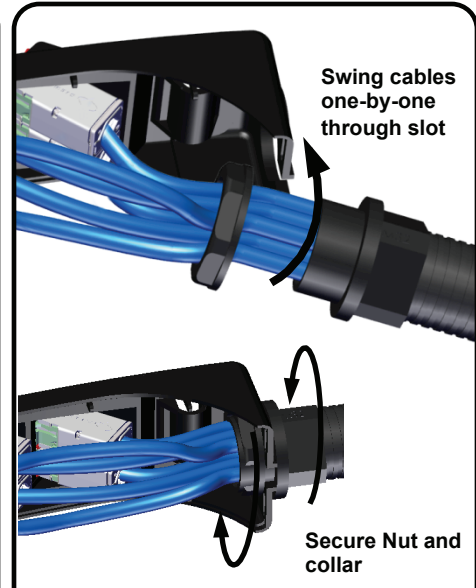

Swing cables one-by-one through slot

Secure Nut and collar

4

Surface Pack Instructions



5

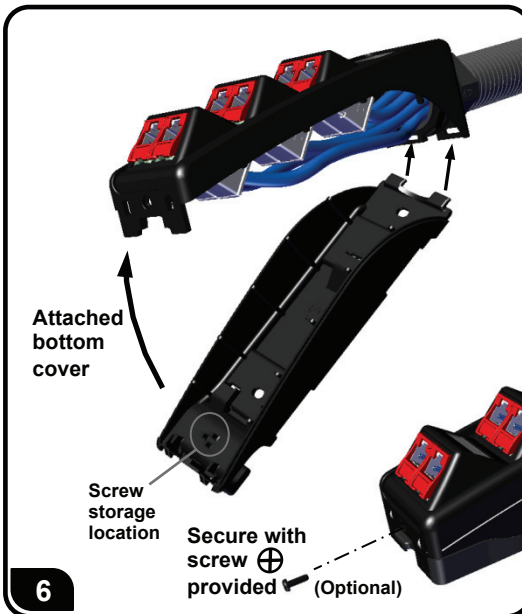

6



7

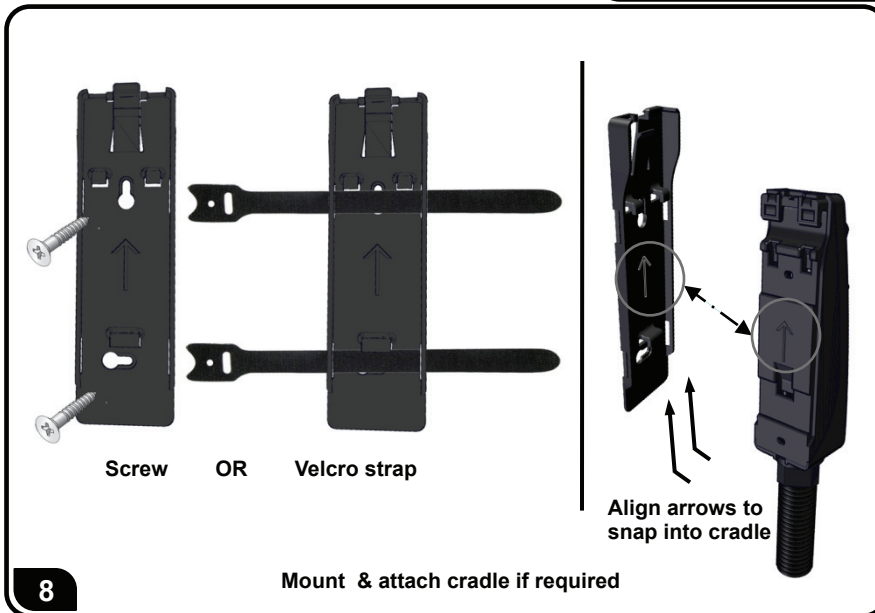

8

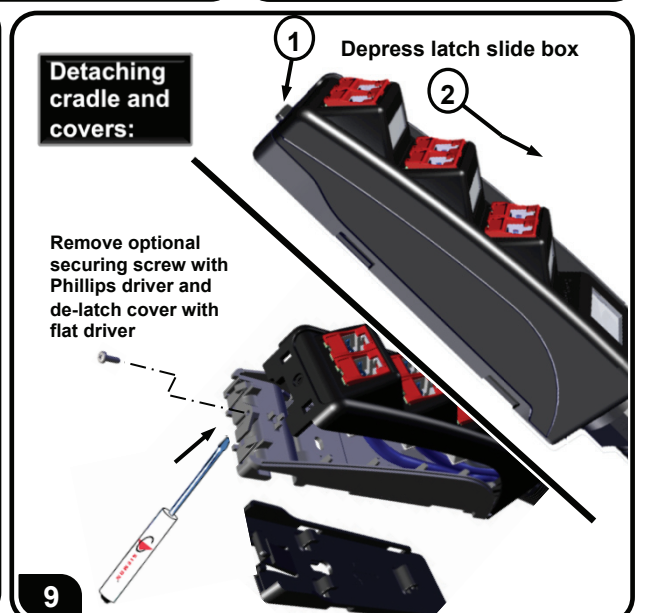

9

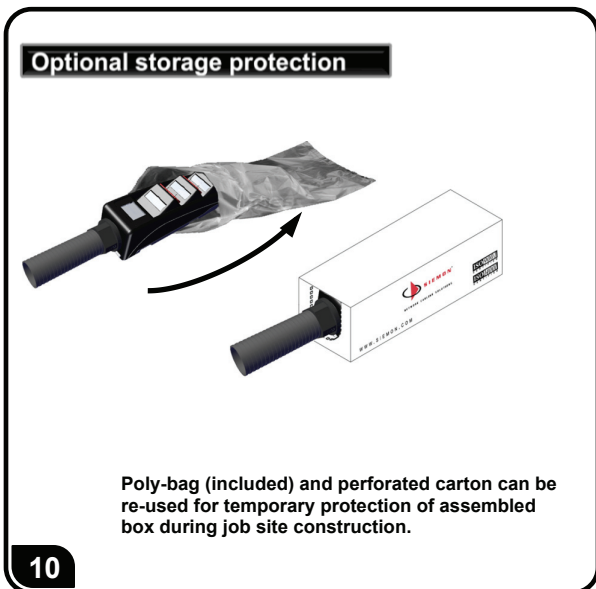

10

To ensure you have the latest revision to this document, please visit: <http://www.siemon.com/us/download/installation.asp#mp>

To assist safe installations, comply with the following:

- A. Use caution when installing or modifying telecommunications circuits.
- B. Never touch uninsulated wire terminals unless the circuit has been disconnected.
- C. Never install this device in a wet location.
- D. Never install wiring during a lightning storm.

Lors de l'installation, respectez les consignes de sécurité suivantes:

- A. Utiliser avec prudence lors de l'installation ou de la modification circuits de télécommunications.
- B. Ne jamais toucher les bornes de fil métallique non isolés sauf si le circuit a été débranché.
- C. Ne jamais installer cet appareil dans un endroit humide.
- D. Ne jamais installer pendant un orage.

Global Headquarters
Watertown, Connecticut USA
Tel: (1) 866-548-5814

