

VersaPOD[®] - Frame Kit Assembly

Required Tools

- 10mm Wrench
- 13mm Wrench
- 24mm Wrench
- T30 Torx Driver



1-2 Gather **six** horizontal brackets [2] and **twelve** torx M6-12 screws [3]. Assemble brackets to middle of frame as shown to **77-83 in-lbs of torque**.

1-3 Gather **two** horizontal frames [4] and **four** torx M6-12 screws. Assemble horizontal frame as shown on both top and bottom to **77-83 in-lbs of torque**.



1-4 Install the 2nd vertical frame with **fourteen** torx M6-12 screws. Assemble to frame as shown to **77-83 in-lbs of torque**.

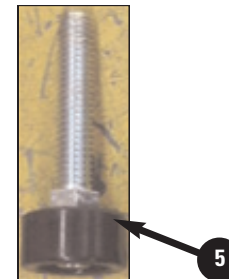
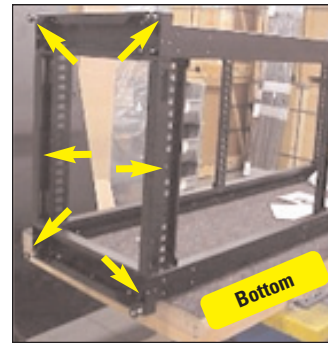

1-5 Insert **six** leveling feet [5] into designated holes on bottom of cabinet frame.

If installing castors, please follow step 1-6. If not, please proceed to step 1-7

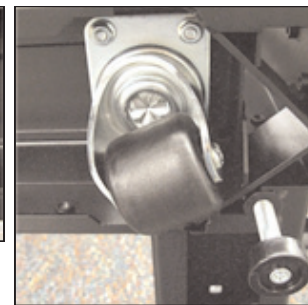
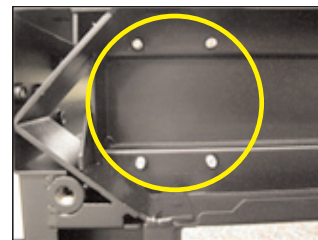
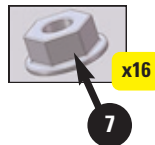

1-6 Gather **four** Castor assemblies [6] and **16** M6 nuts [7]. Install castors onto designated studs on bottom of cabinet frame with M6 nuts as shown.

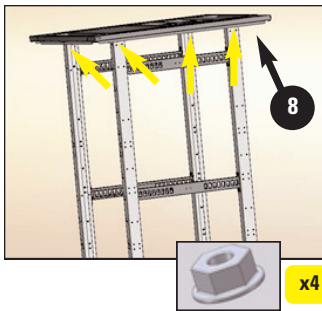

Bottom View

1-7 Gather cover, **four** M6 nuts . Assemble cover [8] onto frame as shown. Curvature on cover determines front of the cabinet.



1-8 Carefully raise cabinet to standing position.

NOTE: Two operators are required to lift and move the frame. Do not attempt to move frame alone.



1-9 Gather base cover plate [9] and assemble to frame as shown using one M6-12 torx screw. Note the **four** latches in the plate and the holes in the frame.

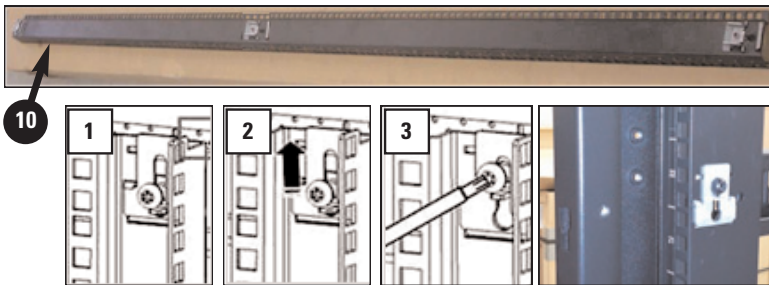

1-10 Gather **two** numbered mounting rails with mounting brackets [10] and **six** M6-12 torx screws. Assemble them to the **rear** of the frame as shown to **35-40 in-lbs of torque**.

NOTE: Curvature on cover determines front of the cabinet.

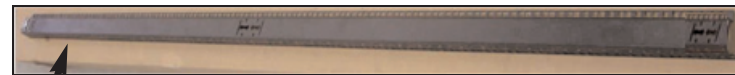

11

Note: Front mounting rails DO NOT include mounting brackets.



1-11 Gather **two** numbered mounting rails **without** mounting brackets [11] and **six** M6-12 torx screws. Assemble them to the **front** of the frame as shown to **35-40 in-lbs of torque**.

NOTE: Curvature on cover determines front of the cabinet.

VersaPOD® - Side Panel Assembly

Side Panels Steps 2-1 to 2-4

NOTE: If side panels are not required, skip to Section 3 (Door Assembly)

VP1(A/B) Side Panel Assembly

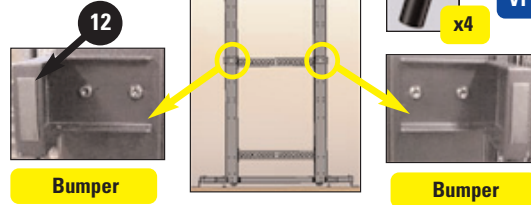

Repeat Steps 2-1 and 2-2 for each VP1A side panel

2-1 Gather lateral side panel brackets [12]. Attach the brackets to the frame as shown using **four M6-12 screws to 77-83 in-lbs of torque.**

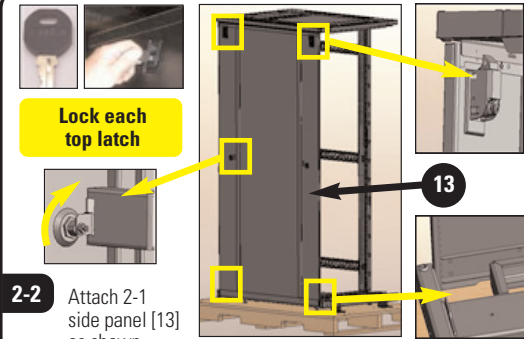

2-2 Attach 2-1 side panel [13] as shown.

VP2A/B Side Panel Assembly (See above for VP1A Side Panel)

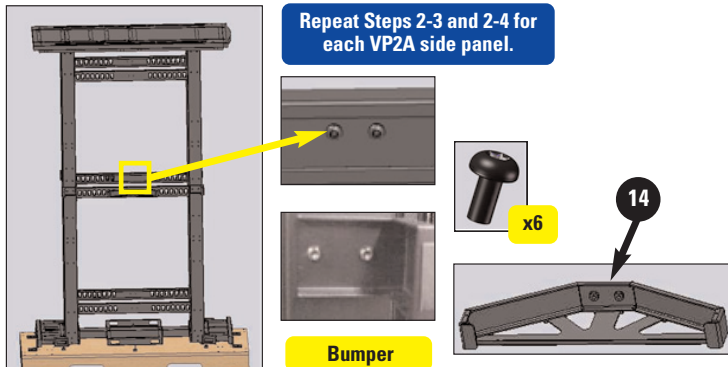

2-3 Gather lateral side panel brackets (same as from step 2-1) and center bracket [14]. Attach the brackets to the frame as shown using **four M6-12 screws to 77-83 in-lbs of torque.**

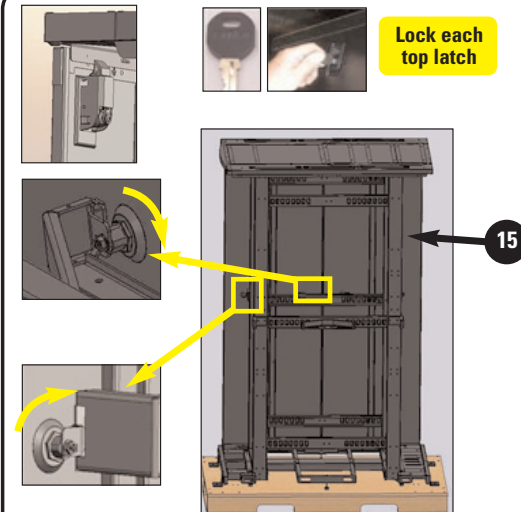

2-4 Gather split side panels [15]. Attach side panels to the frame as shown. Adjust leveling feet heights to eliminate any misalignment in the side panels.

VersaPOD® - Door Assembly

Full Door Assembly

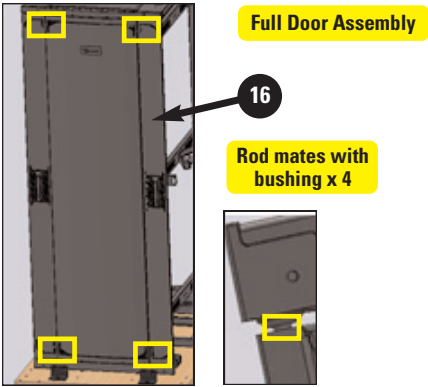

16

Rod mates with bushing x 4

3-1 Gather one full door [16]. Remove keys, if attached to the door and place them aside. Assemble to frame as shown.

Split Door Assembly

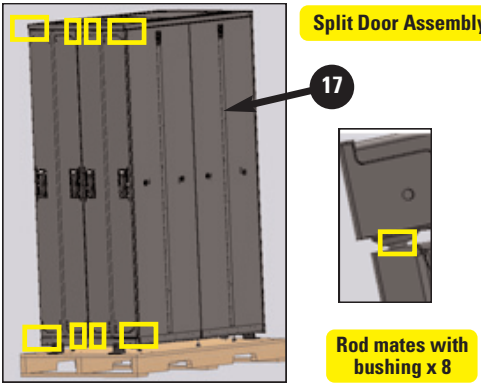

17

Rod mates with bushing x 8

3-2 Gather split doors [17]. Assemble to frame as shown.



18

x4

19

x4

20

3-3 Gather branding plate [18], **four** acorn nuts [19] and **four** M6-32 screws [20]. Attach branding plate. Screws must be inserted from behind.