

# Siemon Colocation Cabinet Instruction

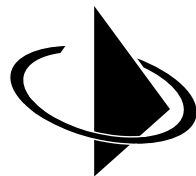

**SIEMON™**

[www.siemon.com](http://www.siemon.com)

# Preface

This manual is provided to prevent service personnel from committing an act that results in the risk of fire, electrical shock, or injury to persons. Only trained service personnel should receive, unpack, and assemble the Siemon CoLo cabinets. In addition, only trained service personnel should install equipment in these cabinets.

## SAFETY SYMBOLS USED IN THIS MANUAL

This manual provides general safety guidelines to be observed during installation, operation, and maintenance of the Siemon CoLo Cabinet.



**WARNING:** Failure to follow directions in the warning could result in injury to persons or loss of life.



**CAUTION:** Failure to follow directions could result in damage to equipment or storage data.



**WARNING:** Improper handling and use of the Siemon CoLo cabinet could result in equipment damage, serious injury, or possible death.

Only trained service personnel should be used to remove the cabinet from the pallet. Also, be sure you have a sufficient number of service personnel. Do not attempt to move the cabinet by yourself.

All wiring and electrical circuits must be in compliance with National & Local electrical codes. Only ITE (Information Technology Equipment) bearing the safety compliance mark of NRTL should be installed inside the cabinet. NRTL compliance marks included UL, C-UL, CSA, ETL, TUV and CE.

Be sure to read and follow all individual manufacturer equipment manuals for safety and installation instructions.

Proper spacing is required when installing electrical equipment to avoid electrical shock. Maintain minimum spacing between the accessories and components and the computer cabinet assembly for safe operation of the equipment when installed in accordance with the NEC ANSI/NFPA 70-1999.

# Safety Information

## INSTALLATION

Receiving, Unpacking, and Removing the Siemon CoLo cabinet from the pallet. Inspect and report and damage before receiving. Unpack the cabinet by carefully removing the corrugated carton and corners. Avoid damaging the cabinet when removing



**WARNING:** Only trained service personnel should be used to remove the cabinet from the pallet. Also, be sure you have sufficient number of service personnel. Do not attempt to move the cabinet yourself.



**WARNING:** Be careful when moving the cabinet before installation. Sudden stops and starts, excessive force, obstructed routes, and uneven floor surfaces may cause the cabinet to topple over.



**WARNING:** Only install equipment after the cabinet has been properly secured. Do not move the cabinet assembly while loaded.

Once in place at the desired/intended location, deploy the leveling feet for maximum stability.

Rated or maximum load capacity of the Siemon CoLo cabinet is 3000lbs (1497kgs) on the floor or on the leveling feet.

To maintain a uniform distribution of the mechanical load in the cabinet, load the heaviest equipment first, at the bottom of the cabinet and load the lighter units at the top.

# Operating Door Handle

The door swing handles have been installed at the manufacturer. No additional assembly is required. To operate the swing handle, lift up at the bottom of the handle then swing the handle to the right to open. The handle must be kept in this position to close the door. Return the handle to the initial position and use the key provided to lock the handle. The lock on the side panels will accept the same key. The swing handles and doors are reversible.

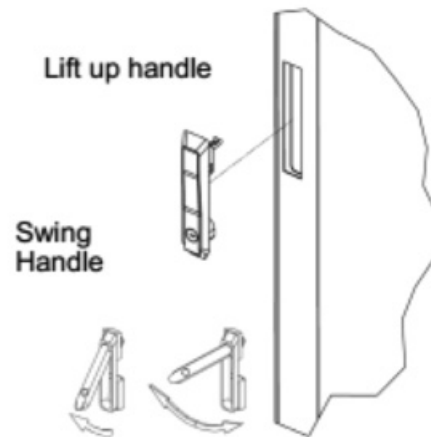
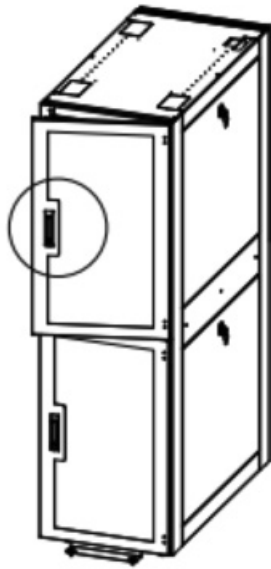

## REVERSING THE DOOR HANDLE

Remove the phillips head bolt from the swing handle retainer on the inside of the door. Tilt the handle outwards and lift up to remove it from the door. Remove the phillips head cam retaining bolt. Rotate the cam 180° and re-install cam retaining bolt. After reversing the door, reinstall the swing handle by sliding downwards into door and tilting inwards. Re-install swing handle retainer and phillips head bolt.

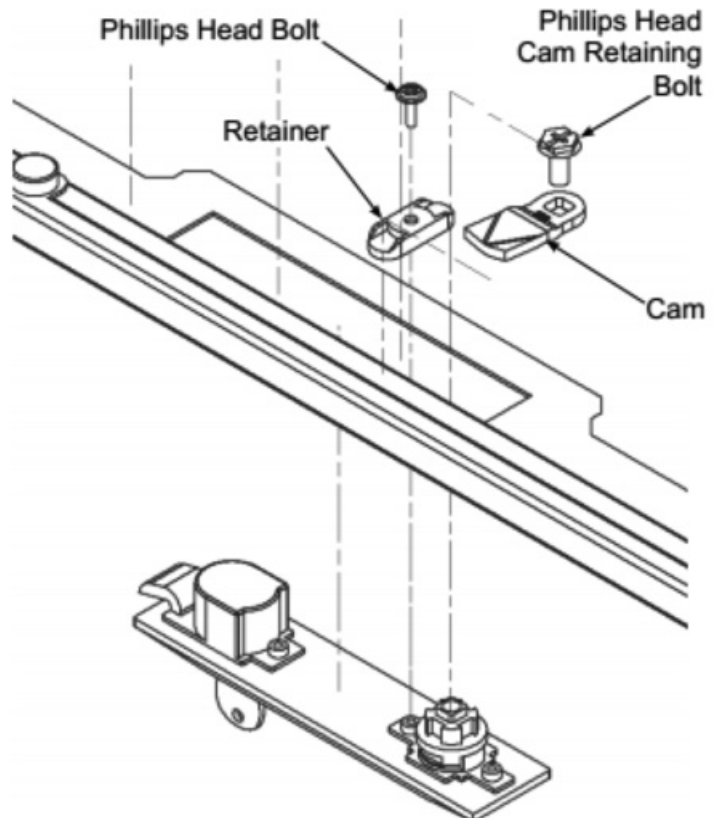

# Door Removal and Attachment

Before removing doors, grounding wires must be disconnected. Open the door beyond 90° then pull on the hinge pins. Carefully pull the door away from the rack to detach the door. To attach the door, align the hinges and slide hinge pins back into the hinge assembly.

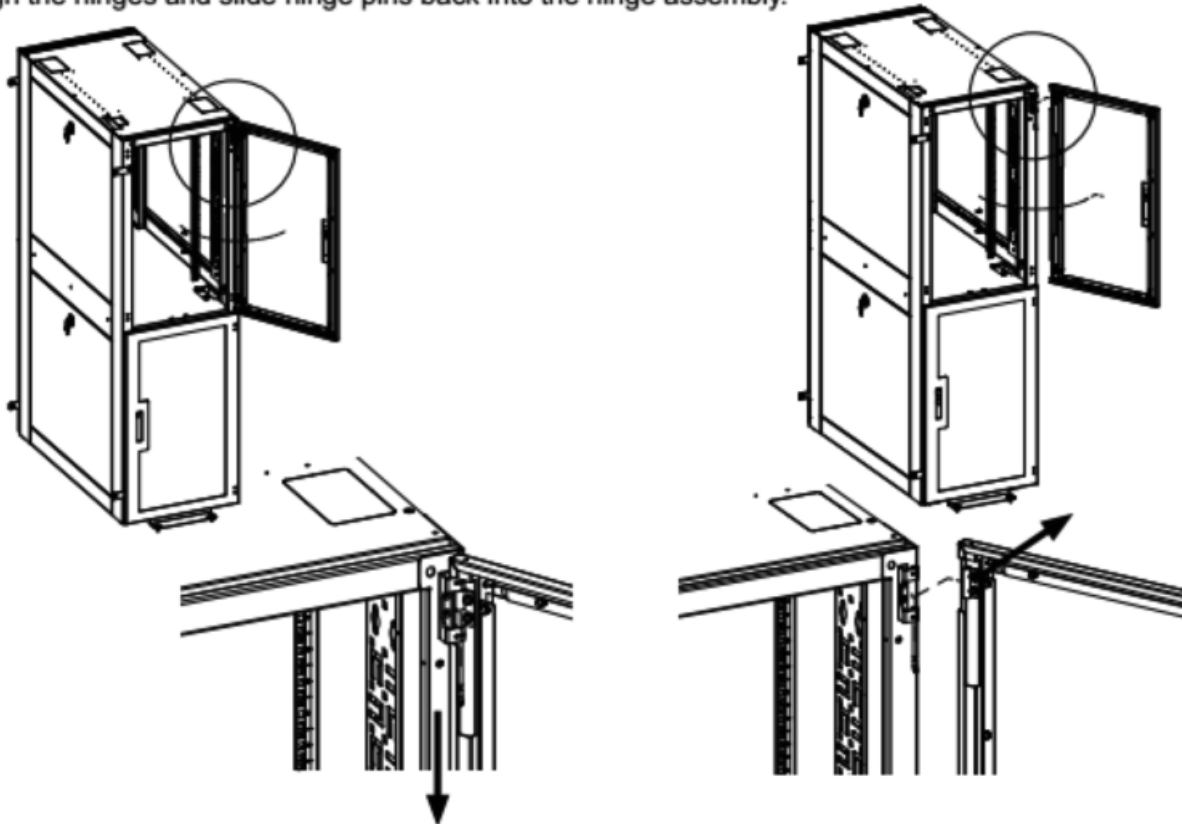

## FIELD REVERSIBLE FRONT & REAR DOORS

The front and rear doors are installed right hand hinged from the factory. To change to left hand hinge, follow door removal instructions then remove the torx screws that attach the hinges to the frame. Re-install the hinges on the left side of the frame using the former top right hinge at the bottom left and the former bottom right hinge at the top left. Note that the open end of the hinges are to face the outside of the rack. Also re-install the catch plate to the opposing side with the bend toward the inside of the rack. Once hinges and the catch plate have been re-installed, rotate the door 180° and slide the hinge pins into the assembly. When the door is reversed, the handle must also be rotated 180° see "Reversing the Door Handle" on page 5.

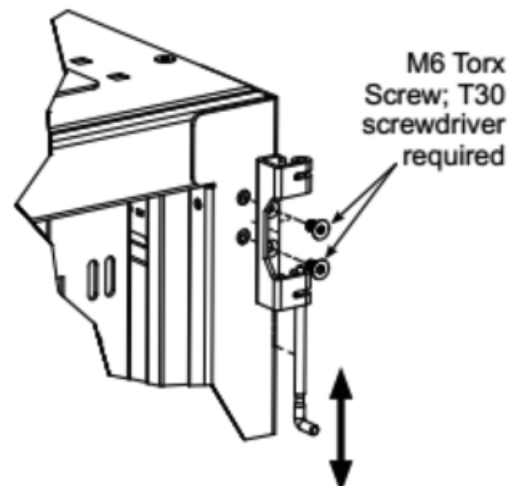

**SIDE PANEL REMOVAL**

Before removing side panels, grounding wires must be disconnected. The side panels are secured to the rack frame with a keyed lock. To remove the side panel, unlock the panel, tilt the top of the side panel out slightly and lift the side panel up a couple of inches until it is free. To install the side panel, reverse the process and lock the panel. Make sure the slots on the side panel engage with the two tabs at the bottom of the frame.

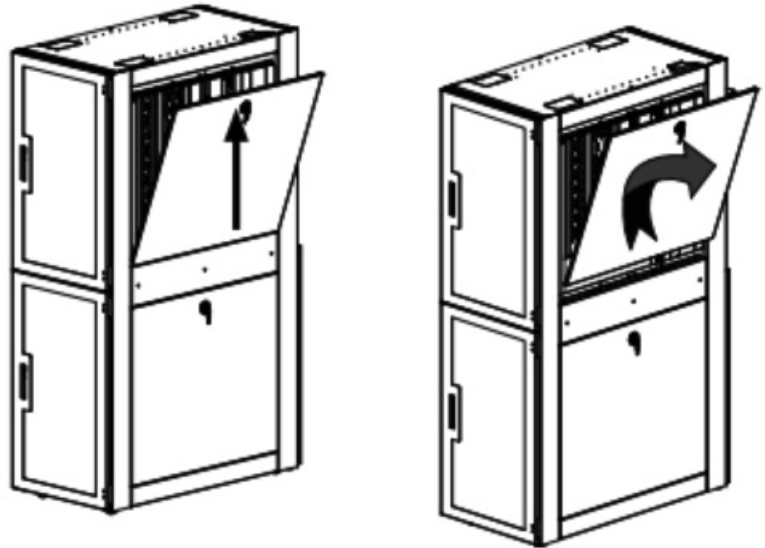

**BOTTOM PANEL MOUNTING**

The bottom panel is installed at the manufacturer. In order to remove, the knockouts front and rear must be removed or the enclosure must be tipped on its side. First remove the (4) M8 bolts behind the knockouts. Secondly remove the 3 M6 Torx screws holding the top panels together. Then tilt and gently lift out the first bottom panel moving it towards the center of the enclosure. Finally tilt and lift out the second bottom panel while moving towards the center of the enclosure.

**First Panel**

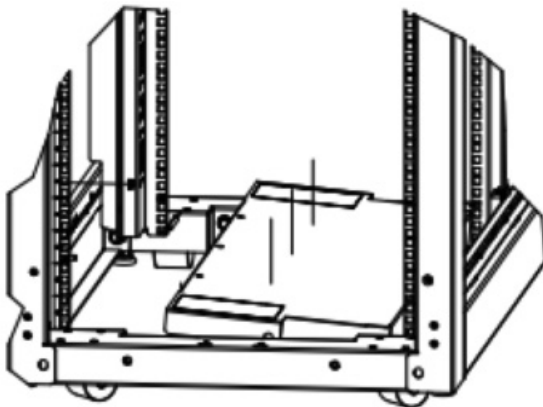

**Second Panel**

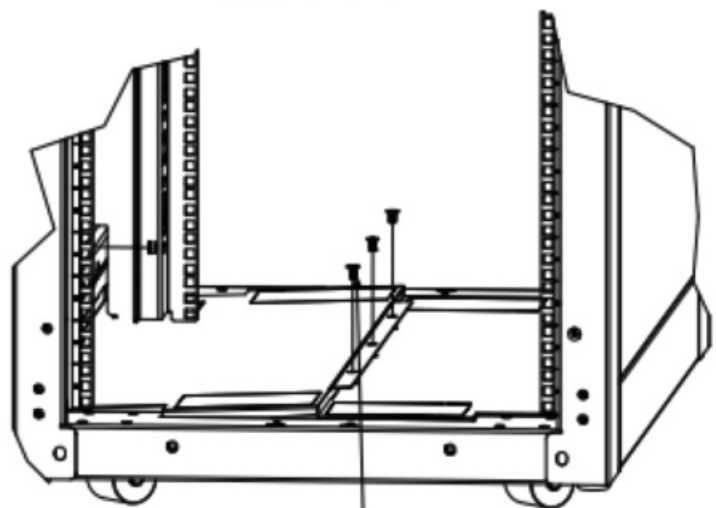

M6 Torx Screw

# Caster and Leveling Feet Mounting



## CAUTION

- To install casters the rack must be tipped onto its side. The rack can be very heavy, several people will be required in this process. Please practice safe lifting techniques.
- DO NOT lay the rack on its front or back, this may damage the door hinges.
- Removing doors and sides will help reduce the weight of the rack.
- Before tipping, remove the side panels to prevent damage to the locks and latches.

## Field installation of casters

1. To install casters, the rack must first be tipped over onto/laid on its side.
2. Swivel casters install on the front of the rack. The longer side of the caster assembly features 2 holes; align the holes over the M8 pem studs that are located on the side of the frame; secure with M8 keps nut and tighten to 18 ft-lb.; see Detail A.
3. The flange of the caster assembly will align with a hole on the side of the frame; secure with a M6 carriage bolt and nut and tighten to 7.5 ft-lb. The shorter side of the caster assembly will align with a hole on the front/rear of the frame; secure with a M8 Bolt and tighten to 18 ft-lb.; see Detail B.
4. Once front swivel caster assemblies are installed, a support bar will connect the two casters. Align the holes on the end of the support beam with the M8 pem studs on the caster assembly; secure with M8 keps nut and tighten to 18 ft-lb.; see Detail A.
5. Fixed casters install on the rear of the rack and are installed in the same manner as the front swivel casters. Repeat steps 2-4; see Detail C.

***Be sure to install swivel casters on the front of the rack and fixed casters on the rear.***

**Detail A - Swivel Caster**

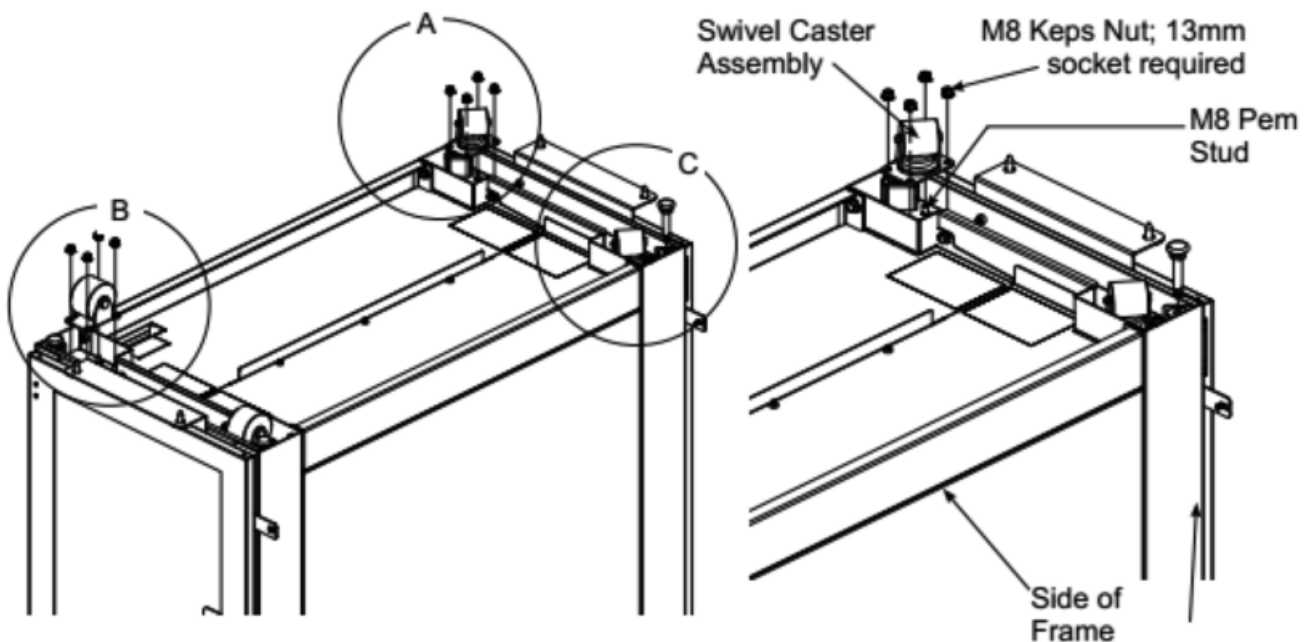

### Detail B - Fixed Caster

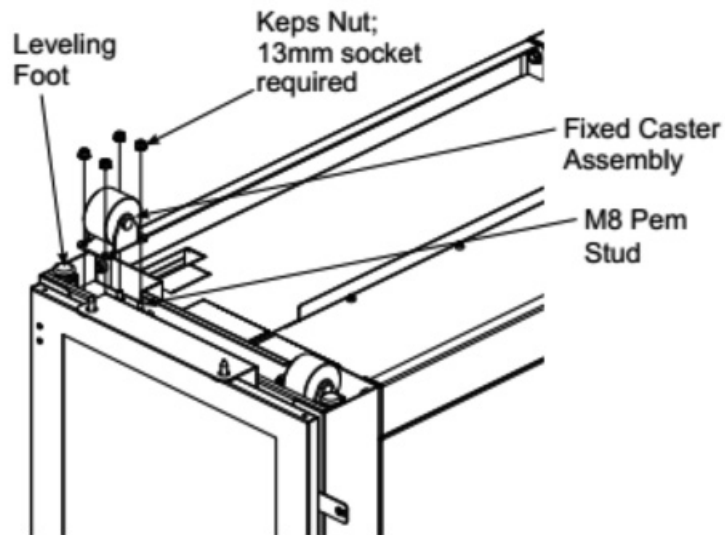

### Leveling Feet Adjustment

Leveling feet are preinstalled at the factory. They are easily accessible in the front and rear of the rack frame. To adjust the leveling feet from inside the rack, a 5/16 socket is required. Leveling feet can also be adjusted from beneath the rack with a 3/4 open end wrench.

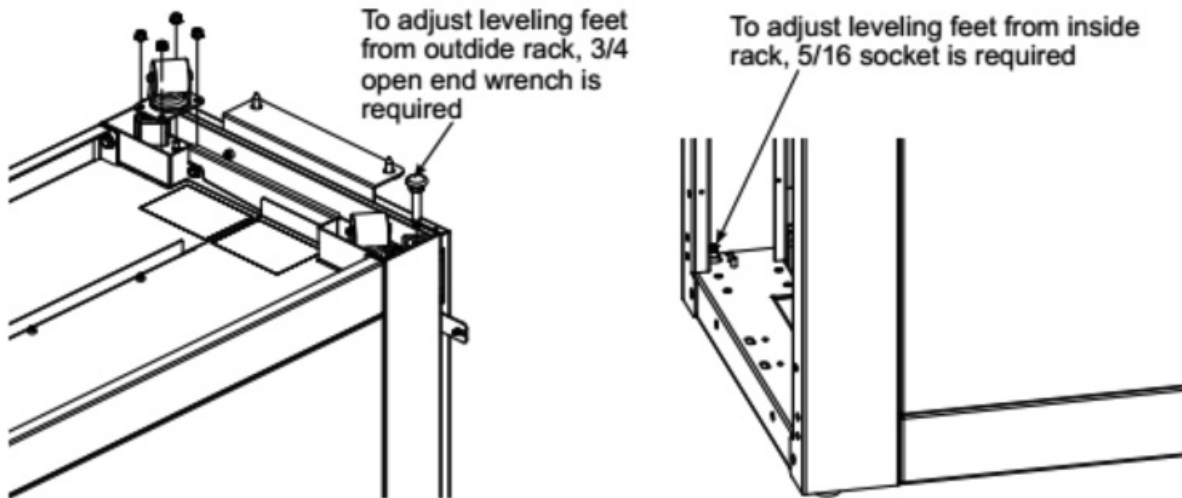

### Detail C - Leveling Feet

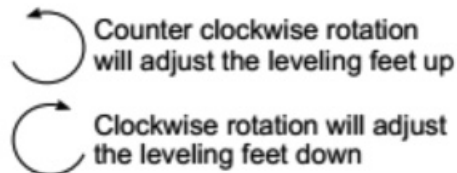

## MOUNTING RAILS

The vertical mounting rails (each rack has two pairs, 12 ga. steel, powder coated rails), come installed with all standard frames at 19" EIA 310-E. Universal cage nut rails (M6) are standard. Rack Mount Units (RU) are marked on the front and rear of the rails for easy equipment mounting. Accessory Mounting Holes (AMH) and vertical cable tie down slots can be found on side of rails.

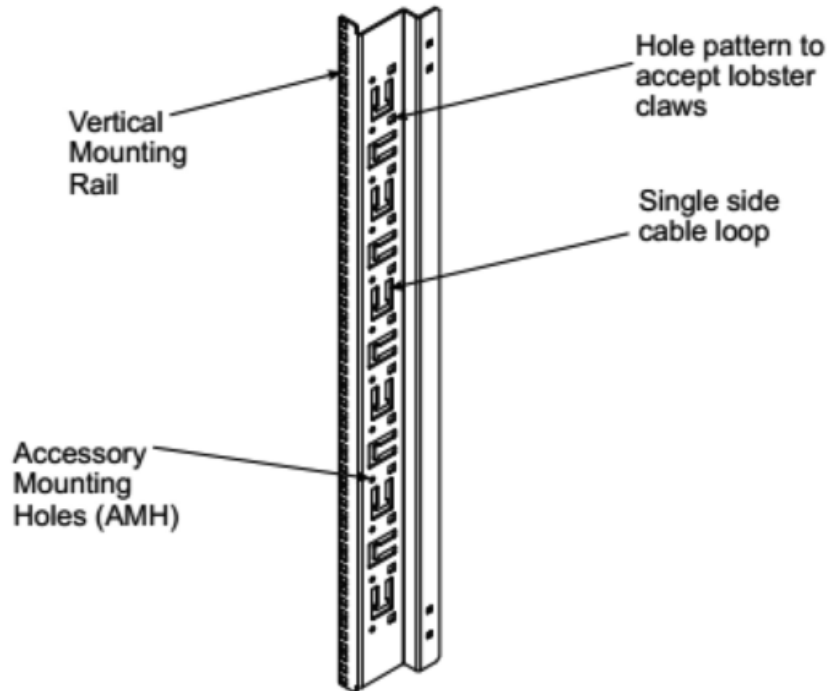

## RAIL ADJUSTMENT

Rails are attached using an M6 carriage bolt and M6 keps nut. By loosening the top bottom and middle bolts using a 10mm drive socket, the rails can be adjusted infinitely from front to back. **Do NOT attempt to adjust rails once equipment has been loaded.**

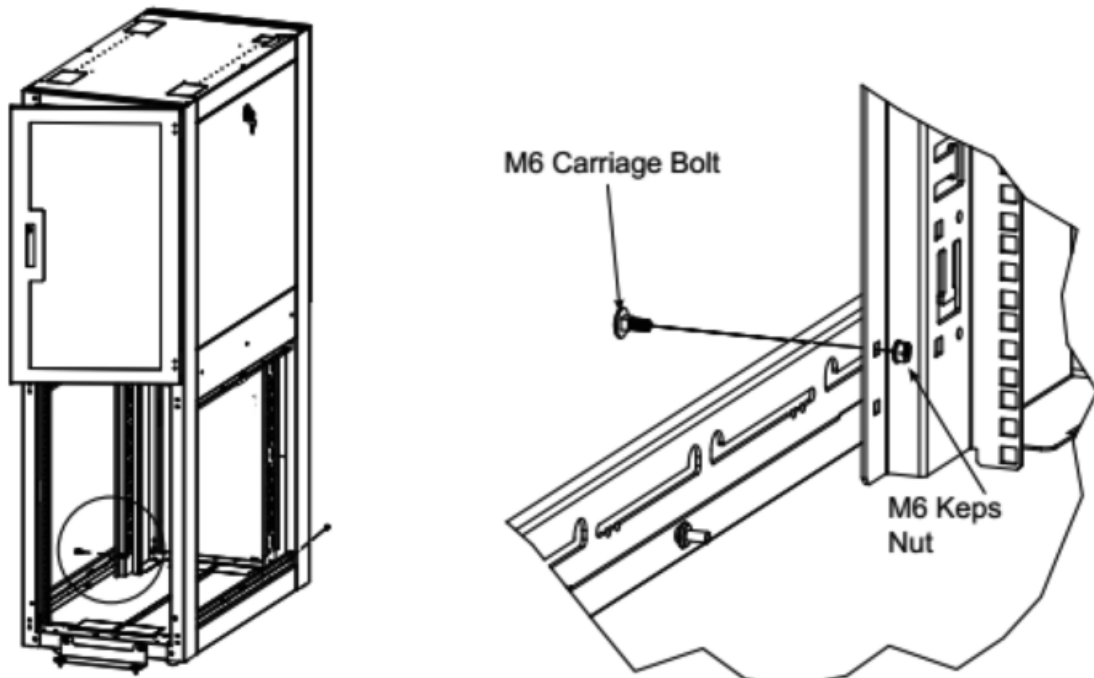

**CAUTION:** Only loosen the hardware enough to allow the rails to move. If loosened too much, the side panel of the cabinet will need to be removed to access this hardware.

# PDU/Cable Management Brackets

## PDU/CABLE MANAGEMENT BRACKETS

PDU/Cable Management Brackets can be installed in each rear corner of the rack. They are secured to the rack at the top, center, and bottom rack horizontal. Keyhole cutouts along the bar accept button mounting of PDUs. The rectangular hole pattern accepts "D" rings, lobster claws, and a variety of other cable management.

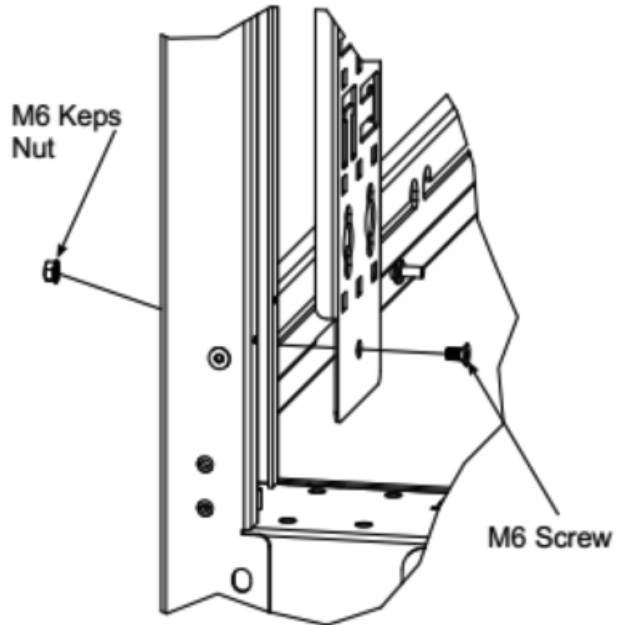

### POWER

When using power distribution units (PDUs), each PDU should be connected to a dedicated branch circuit that is rated for the continuous load of all the equipment connected. When not using a PDU, each piece of equipment should be connected to a dedicated branch circuit.

**CAUTION:** Only loosen the hardware enough to allow the bracket to move. If loosened too much, the side panel of the cabinet will need to be removed to access this hardware.

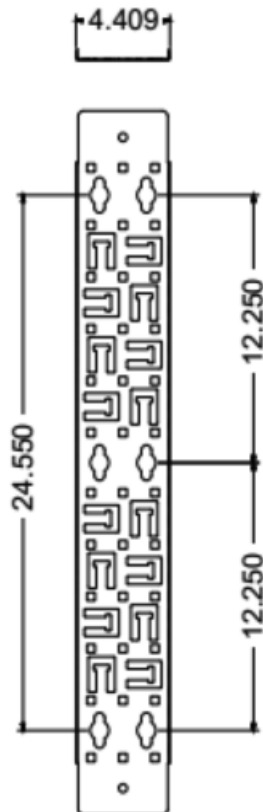

# Baying to V6/V8 Cabinets

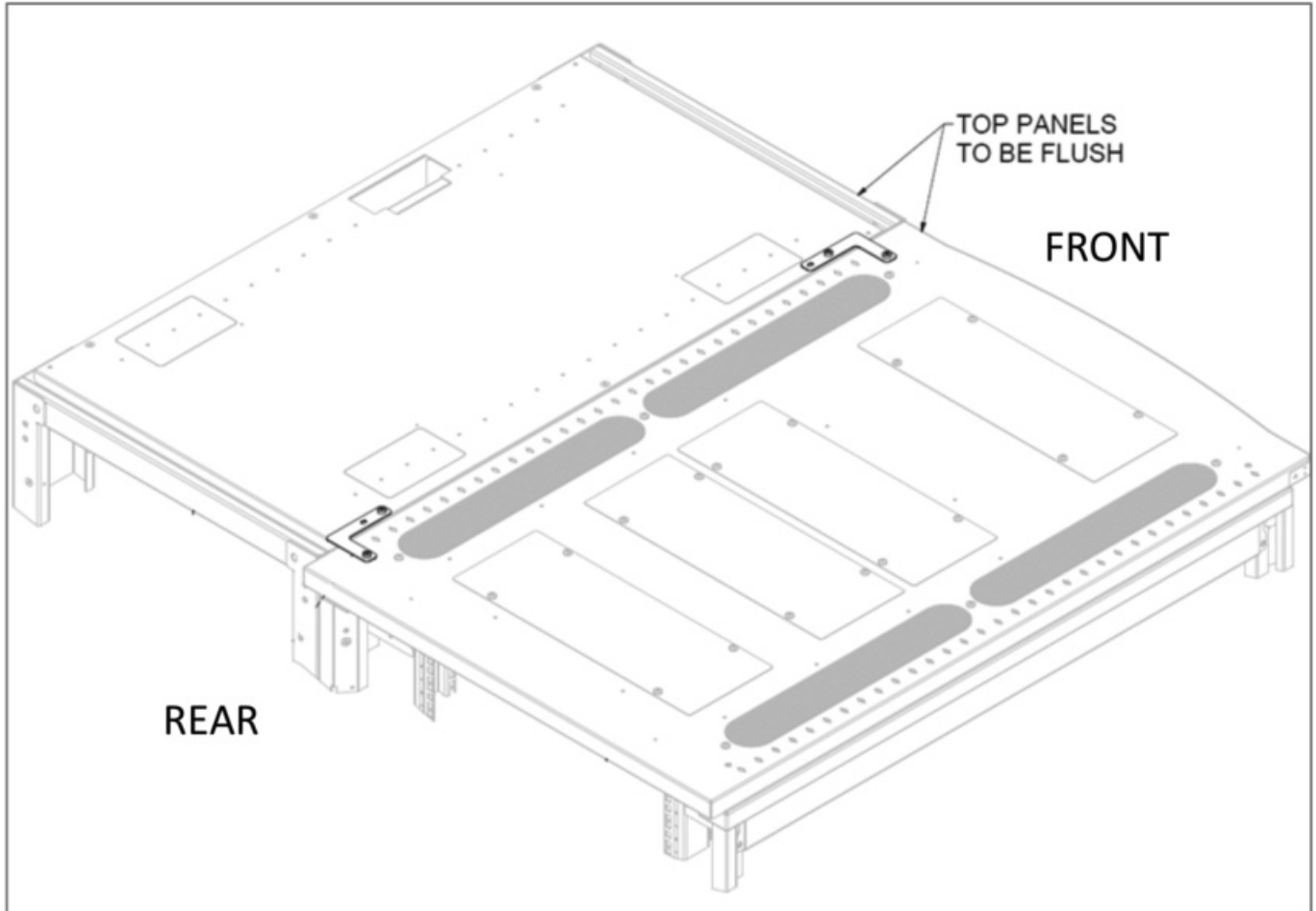

# Bonding

