

# Moray Active Optical QSFP Cable Assembly Installation and Handling Quick Reference

These guidelines refer to Siemon part numbers QSFP-F-(XXX) and QSFP-FA-(XXX)

## Installation Guidelines

- Do not remove protective wrapping from the QSFP module until immediately prior to plugging into system.

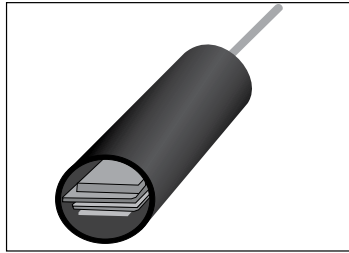

- Use Siemon Pull Sock (P/N QFSP-F-PS) when routing through conduit and cable trays.



- Insert QSFP module by grasping connector boot.

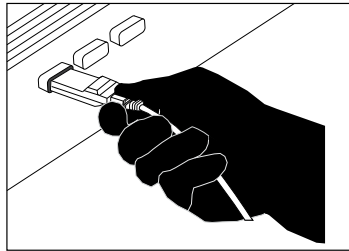

- Remove QSFP module by grasping pull tab.

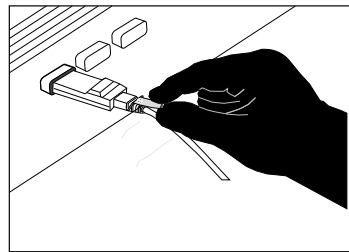

## Handling Guidelines

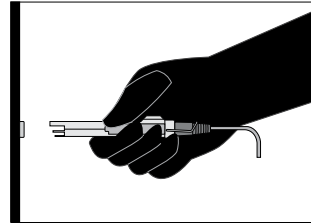

Handle by module

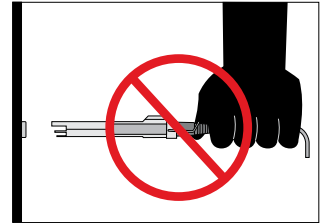

Do NOT handle by cable

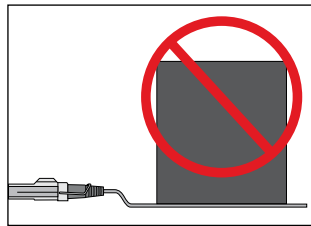

Do NOT crush the cable

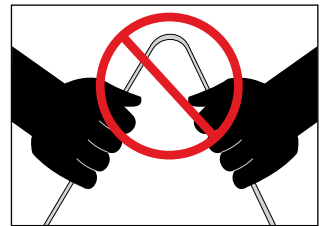

Do NOT kink the cable

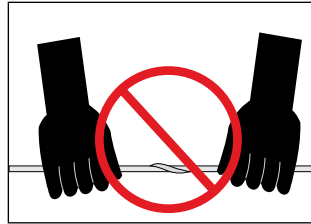

Do NOT twist the cable

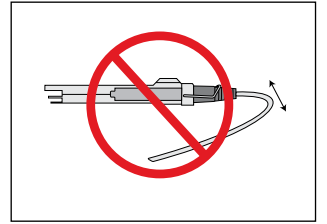

Do NOT overbend the cable

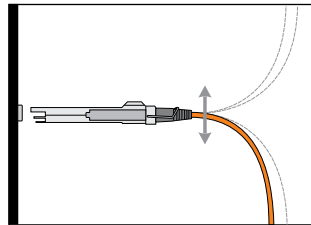

Cable can bend up and down

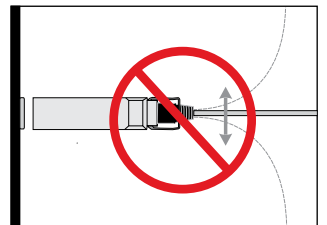

Do NOT excessively bend the cable side-to-side

**For additional resource information:**  
Visit our website at [www.siemon.com/IS](http://www.siemon.com/IS)

**Siemon Interconnect Solutions**  
Watertown, Connecticut USA  
Phone (1) 860-945-4213  
E-Mail - Customer Service - [IS\\_customerservice@siemon.com](mailto:IS_customerservice@siemon.com)  
E-Mail - Technical Support - [IS\\_techsupport@siemon.com](mailto:IS_techsupport@siemon.com)

