

# Surface Mount Boxes

Surface mount boxes feature a sleek compact, easy-to-install design. UTP, shielded, fiber, video, and coax MAX,® Z-MAX® or TERA® outlets can be quickly installed into the base. Multiple cable management features provide a high performance and well organized installation.

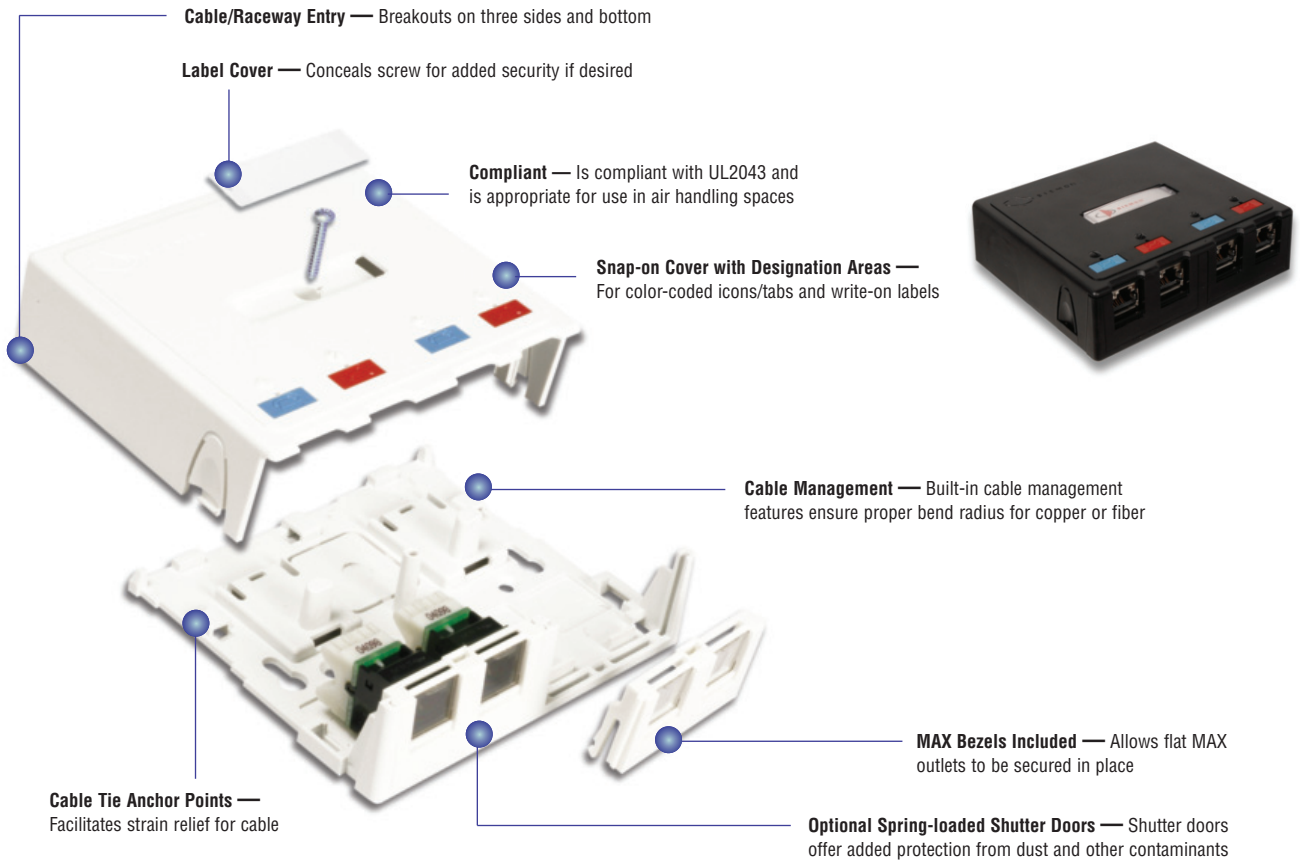

## MX-SM Surface Mount Boxes

Field-assembled surface mount boxes with MAX® bezels. Accepts flat single port MAX outlets ordered separately.



MX-SM1-(XX) . . . . .  
1-port box with cover, base, one single port MAX bezel, cable ties, adhesive tape and mounting screws

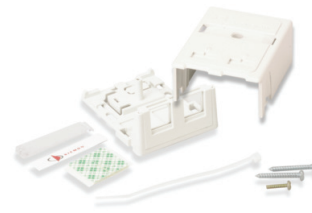

MX-SM2-(XX) . . . . .  
2-port box with cover, base, one (2-port) MAX bezel, cable ties, adhesive tape, mounting screws, and designation labels



MX-SM4-(XX) . . . . .  
4-port box with cover, base, two (2-port) MAX bezels, cable ties, adhesive tape, mounting screws, designation labels and label covers



MX-SM6-(XX) . . . . .  
6-port box with cover, base, three (2-port) MAX bezels, cable ties, adhesive tape, mounting screws, designation labels and label covers

Use (XX) to specify color: 01 = black, 02 = white, 20 = ivory, 80 = light ivory  
Add "-D" for optional spring shutter doors.  
Add "-M" for optional magnets.  
Add "-MD" for optional doors and magnets.

MAX bezels are compatible with all single port, flat MAX outlets. For LC, SC duplex fiber adapters, Z-MAX® and TERA® options, see MX-SM multimedia bezels below.

# ORDERING INFORMATION

## MX-SM Multimedia, SC Bezels and Blanks



MX-SMB-MM-(XX) . . . . .  
2-port multimedia bezel



MX-SMB-SC-(XX) . . . . .  
2-port bezel with one  
duplex SC adapter\*



MX-SM-BLNK-(XX) . . . . .  
1-port blank insert for  
MAX bezels

Use (XX) to specify color: 01 = black, 02 = white, 20 = ivory, 80 = light ivory.

\*SC adapters are "universal" to support both multimode and singlemode.

Note: Multimedia bezel accommodates Z-MAX®, TERA® outlets and flat MAX duplex LC adapters.

They are also compatible with all other single port flat MAX modules, but require the use of icons to secure modules into bezel.

## Z-MAX Surface Mount Boxes

MX-SMZ(X)-(XX)-(X) . . . . . Z-MAX Surface mount box with cover base, 2 port multimedia bezel, cable ties, adhesive tape and mounting screws

Ports	Options
1 = 1 port	(Blank) = n/a
2 = 2 port*	M = magnets
4 = 4 port*	
6 = 6 port*	
	Color
	01 = Black
	02 = White
	20 = Ivory
	80 = Light Ivory

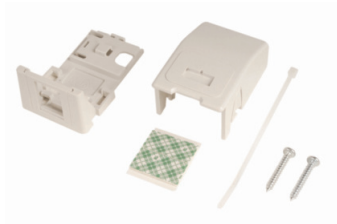

\* Includes designation labels and label covers

Also for use with single-port flat and duplex LC adapter modules and TERA outlets.



**North America**  
Watertown, CT USA  
Phone (1) 860 945 4200 US  
Phone (1) 888 425 6165 Canada

**Europe/Middle East/Africa**  
Surrey, England  
Phone (44) 0 1932 571771

**Asia/Pacific**  
Shanghai, P.R. China  
Phone (86) 21 5385 0303

**Latin America**  
Bogota, Colombia  
Phone (571) 657 1950